

12" CORNER INSTALLATION

Additional reinforcing is necessary on all corners to keep them from shifting during the pour. If using CELBLOX® Block Lock, they should be snapped around the top pin bracket on each corner and the top pin bracket on the adjacent straight block. Corners can also be reinforced by wrapping lumber or cut pieces of OSB or plywood completely around the corner and overlapping adjacent straight block two webs on either side of the corner.

Step 1

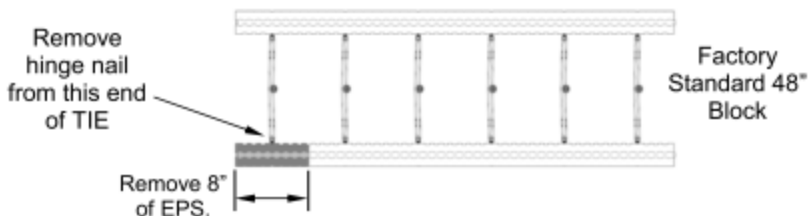

Step 2

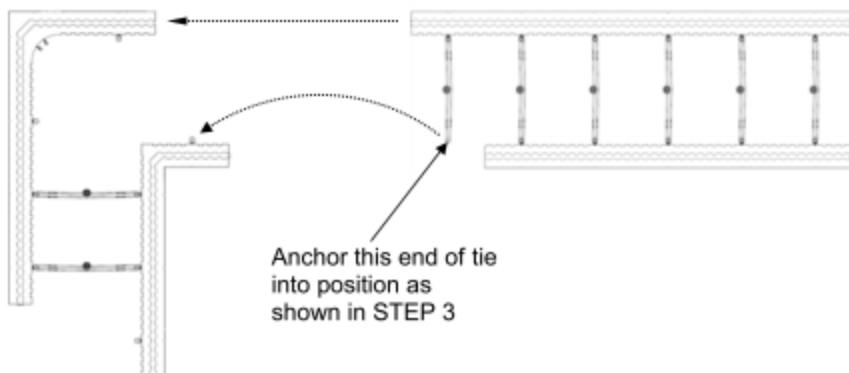

Step 3

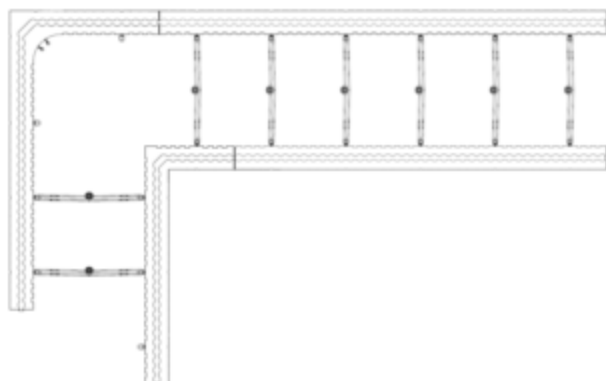

Step 4

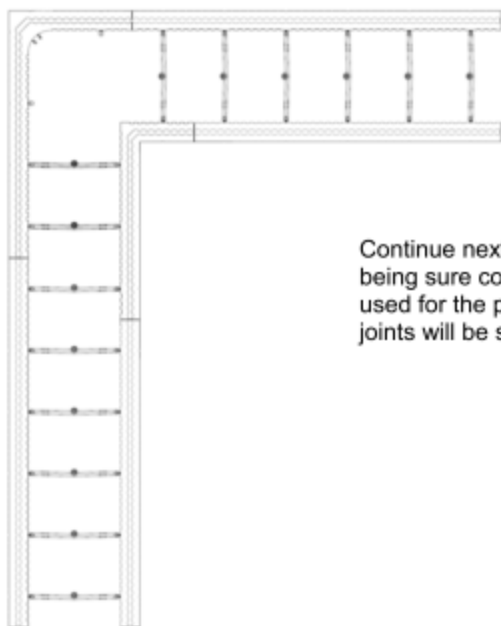

Continue next course in same manner being sure corners are opposite those used for the previous course so the joints will be staggered 16" on center.

INSTALLATION OF METAL TIES IN 12" CORNERS

Walls over 12' in height require the use of optional metal ties to supplement support from inside and outside of the wall. There are two types of "straps", as seen in the photographs, which are inserted into place in the field.

This type strap, CELBLOX® BlockLock, is used to bridge

